

# Magnetic Grippers

## Magnetic Grippers MGM

Suction area: ( $\varphi$ ) 30mm to 70mm

Magnetic Grippers MGM



### Introduction and application

- ◆ Magnetic gripper for handling of perforated metal sheets, laser cutting parts with complex geometry
- ◆ Handling of ferromagnetic workpieces

### The ordering data of Magnetic Grippers MGM

## MGM 30 G1/8-IG PNP

① ② ③ ④

| ① model | ② size                                     | ③ Specification of connector               | ③ Sensor   |                                    |
|---------|--|--|--|------------------------------------|
| MGM     | 30 - $\varphi$ 30mm<br>40 - $\varphi$ 40mm | 50 - $\varphi$ 50mm<br>70 - $\varphi$ 70mm | Blank-Separate suction cup<br>G 1/8-IG - G 1/8 internal thread<br>G 1/4-IG - G 1/4 internal thread | Blank-without sensor<br>PNP<br>NPN |

注:IG表示内螺

### The model specification of Magnetic Grippers MGM

| Type        | G 1/8-IG | G 1/4-IG |
|-------------|----------|----------|
| MGM 3 0     | ●        | -        |
| MGM 3 0 PNP | ●        | -        |
| MGM 3 0 NPN | ●        | -        |
| MGM 4 0     | -        | ●        |
| MGM 4 0 PNP | -        | ●        |
| MGM 4 0 NPN | -        | ●        |
| MGM 5 0     | -        | ●        |
| MGM 5 0 PNP | -        | ●        |
| MGM 5 0 NPN | -        | ●        |
| MGM 7 0     | -        | ●        |
| MGM 7 0 PNP | -        | ●        |
| MGM 7 0 NPN | -        | ●        |

# Magnetic Grippers

## Magnetic Grippers MGM

Suction area: ( $\varnothing$ ) 30mm to 70mm



### Selection guide of sensor spare parts

| Magnetic switch model | Switch output mode | Suitable for suction cups |
|-----------------------|--------------------|---------------------------|
| D-Y59A                | NPN                | MGM 30 / 40/50/70         |
| D-Y7P                 | PNP                | MGM 30 / 40/50/70         |



### Technical Data Magnetic Grippers MGM

| Type           | Suction force<br>[N] | Residual Stress<br>[N] | Operating pressure<br>[bar] | Control pressure range<br>[bar] | Operating temperature | Weight<br>[g] |
|----------------|----------------------|------------------------|-----------------------------|---------------------------------|-----------------------|---------------|
| MGM 30 G1/8-IG | 35                   | 0.3                    | 3.5...6                     | -0.6                            | 5...70                | 130           |
| MGM 40 G1/4-IG | 100                  | 0.3                    | 3.5...6                     | -0.6                            | 5...70                | 240           |
| MGM 50 G1/4-IG | 180                  | 0.3                    | 3.5...6                     | -0.6                            | 5...70                | 440           |
| MGM 70 G1/4-IG | 290                  | 0.3                    | 3.5...6                     | -0.6                            | 5...70                | 715           |



### Design Data Magnetic Grippers MGM

MGM 30 to 70

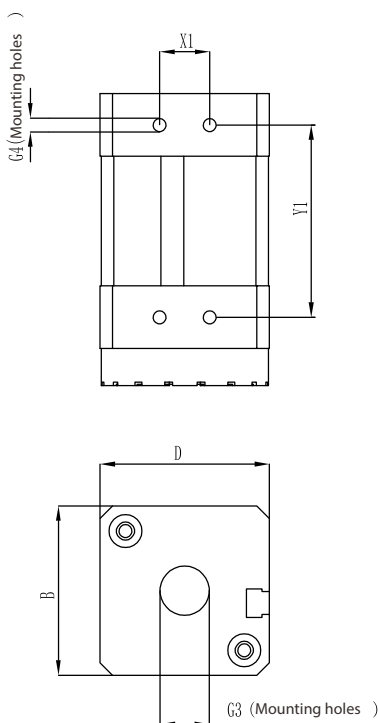

| Type           | Dimensions[mm] |      |      |    |    |      |      |      |    |  |
|----------------|----------------|------|------|----|----|------|------|------|----|--|
|                | B              | D    | H    | X1 | Y1 | G1   | G2   | G3   | G4 |  |
| MGM 30 G1/8-IG | 29.5           | 29.5 | 70.2 | 12 | 46 | G1/8 | G1/8 | G1/8 | M4 |  |
| MGM 40 G1/4-IG | 40.5           | 40.5 | 69.8 | 12 | 46 | G1/8 | G1/8 | G1/4 | M4 |  |
| MGM 50 G1/4-IG | 50.5           | 50.5 | 80.2 | 15 | 58 | G1/8 | G1/8 | G1/4 | M5 |  |
| MGM 70 G1/4-IG | 68.0           | 68.0 | 80.2 | 15 | 58 | G1/8 | G1/8 | G1/4 | M5 |  |